

MYSTERY AT THE QUILT RETREAT

Tea Cups and Half-Square triangles

Half-Square Triangle Units

Half-square triangles again? Yes again. By now everyone should be an expert at making half-square triangles. This month we will be making a total of 12 half-square triangles. If you are using directional fabric you will need to make 14 half-square triangles. Chose two coordinating fabrics to make the half-square blocks. If you want to get adventuresome you could choose two colors and make scrappy half-square triangles using different fabrics in the two-color choice. (I used the background as my light and chose two coordinating fabrics to make two different colored half-square blocks. I then alternated the half-squares when they were assembled).

Cut (6) 3 inch squares (7 if directional fabric) from each of the two fabrics chosen. Draw a diagonal line on the back of the lightest fabric. Now pair three of these squares with the coordinating fabric. Sew the squares together $\frac{1}{4}$ inch on either side of the marked line to form your half-square triangle blocks. Cut on the marked diagonal line. Press your seam to the dark fabric side. Make sure the half-square triangle block measures $2\frac{1}{2}$ inches square with seam allowance. You may need to trim the block. Using the diagonal line on the ruler, square up the block to $2\frac{1}{2}$ inches. You should have a total of 12 new half-square blocks (14 if you used 7 squares for directional fabric). Cut a $2\frac{1}{2}$ inch square of the lighter fabric. Sew it to the end of the vertical row as pictured below.

Horizontal segment

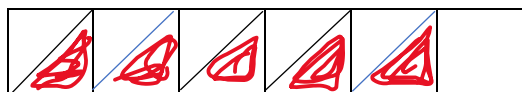

Vertical segment



Sew 5 of the half-square triangle horizontally with the darker fabric on the bottom.

Sew the $2\frac{1}{2}$ inch square on the end of this segment.

Sew 7 of the half-square triangles vertically with the darker fabric on the top.

Refer to the two illustrations for fabric placement.

Put the horizontal half-square triangle strip with your other project segments for usage when assembling the Mystery Quilt. We are only going to use the vertical segment this month.

Tea Cup Blocks



<http://www.thesewingchick.com/2014/02/teacup-block-tutorial/>

We will be making two tea cup blocks. If you get into difficulty following my directions I have included the location of a free tutorial for this block. You can either make your tea cups the same or two different cups. If you are going to make two different tea cups make sure you modify the cutting directions for the tea cup, saucer and handle. The cutting directions are for two exactly the same. There is an illustration later that shows the placement of each cut. You can refer to it if using directional fabric or a different fabric for each tea cup.

Cutting Directions

Tea cup	Background	saucer	handle
(2) 4 inch squares one for each cup	(1) **1 ¾ by 14 inch strip (2) 2 x 6 ½ inch rectangle (4) 1 inch squares (1) **1 ½ by 10 inch strip (1) *2 ½ by 22 inch strip (This can be a coordinating fabric other than the background because it will connect the two tea cup blocks similar to a border.)	(2) 1 ½ by 6 ½ rectangle one for each saucer	(4) 1 x 1 ¾ in rect. (2 rectangles for each handle) (2) 1 x 1 ½ rect. (1 rectangles for each handle)

We will be sub-cutting the (4) four strips of background fabric into squares and rectangles. (If you have a directional fabric the strip cutting will not be possible because we will be turning the pieces to form the handle.) ** If you are using a directional fabric you will need to cut these background pieces individually (2) 1 ¾ x 4 inches, (2) 1 ¼ x 1 ½, (2) 1 x 1 ¾ and (2) 1 ½ x 1 ¾, (4) 1 ½ inch squares (they are pieces that are included in the longer strips). The other background pieces are listed in the cutting directions.

(these strips are longer than needed)

Sub-cut the 1 ¾ by 14 inch strip into (2) 1 ¾ x 4 inch, (2) 1 ¾ x 1 inch, (2) 1 ¾ x 1 ½ inch pieces

Sub-cut the 1 ½ by 10 inch strip into (4) 1 ½ inch squares, (2) 1 ½ x 1 ¼ inch pieces

Sub-cut the 2 ½ x 22 inch strip into (2) 2 ½ by 6 ½ inch rectangles and (1) 2 ½ by 8 ½ inch rectangle (*these cuts will be used to join the two tea cups together to form a 8 ½ by 14 ½ finished segment. It

does not need to be background fabric. A coordinating fabric may be used since these strips are border strips. Remember, if a directional fabric is used the strip method of cutting will not work. Pieces will need to be cut individually.)

Use the diagram at the right so you know where your Pieces will be placed. If you are using a directional Background fabric, use the illustration to cut your pieces. Remember we are making two blocks using this pattern.

Mark a diagonal line on the back of the 1 inch and 1 ½ inch background squares. Please note that the diagonal should go in opposite directions because of being placed on either side.

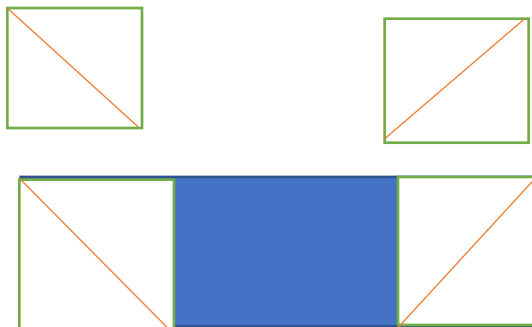

Place a 1 ½ " background square on each end of the saucer piece, with the diagonal lines in the direction pictured and sew on the lines. Trim seams to ¼ " and press.

Place the 1" background squares on each end of the 4" tea cup piece, with the diagonal lines in the same direction as used for the saucer (see above illustration) and sew on the diagonal line. Trim seam to ¼ inch and press

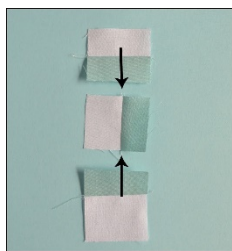

We will be assembling the handle next. Sew the 1 x 1 ¾ inch background rectangle to the same size handle fabric. Press to the dark side. ↓

Sew the 1 ¼ x 1 ½ inch background fabric to the 1 x 1 ½ handle fabric. Press →

Sew 1 x 1 ¾ handle fabric to the 1 ½ x 1 ¾ background fabric. Press ↑

Sew the units together as shown in the illustration to the left.

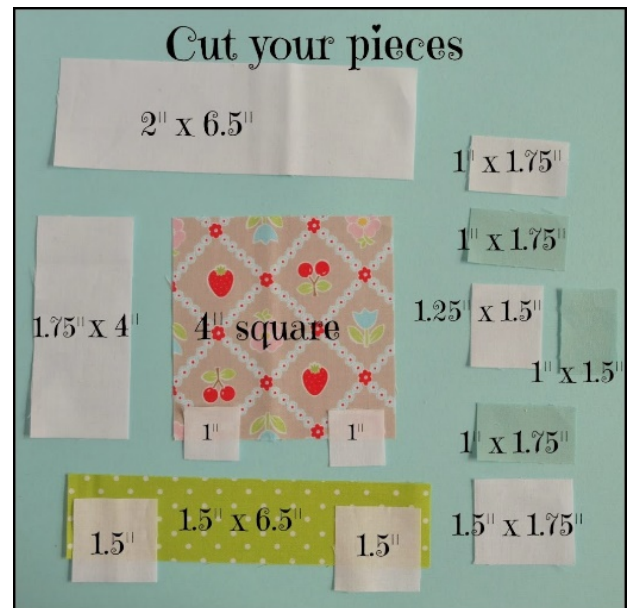

Sew the 1 ¾ x 4" background rectangle to the left side of the teacup square.

Sew the handle unit to the right side of the tea cup square. Press seams towards the tea cup as indicated in the illustration to the left.

Sew the 2 x 6 ½ inch background rectangle to the top of the new unit and the saucer unit to the bottom. Press both seams towards the center unit as indicated by the arrows at the right. You have completed the tea cup block portion of this month's mystery segment. The tea cup should measure 6 ½ inches square with seam allowance.

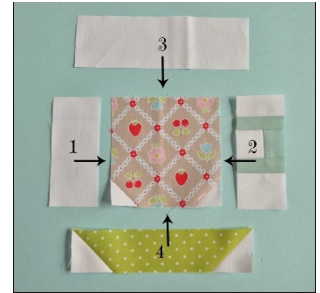

ASSEMBLY DIRECTIONS

Sew one 2 ½ x 6 ½ inch rectangle (either background fabric or a coordinating fabric) to the left side of one of your tea cup blocks. Sew the other 2 ½ x 6 ½ inch rectangle to the right side of the other tea cup block. Press the seam towards the border away from the tea cup block.

The block with the border on the left will be on the top of your finished segment. Sew the 2 ½ x 8 ½ inch rectangle to the bottom of this block (The one with the border on the left). Press the seam into the border.

Now sew the second tea cup block with the border on the right to the bottom of the newly constructed segment. Press the seam towards the border. The borders should follow the arrows illustrated below. The tea cup blocks are the white squares and the arrows indicate placement of the border or background fabric. The finished segment should measure 8 ½ by 14 ½ inches with seam allowance.

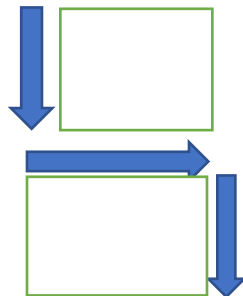

Now sew the vertical 7 half-square triangle unit to the right side of the tea cup segment. The finished size of your final segment should measure 10 ½ x 14 ½ inches with seam allowance.

DESIGN HINT

I used two different color choices for my tea cups. I did not choose a print for the cup portion of the block. Instead I used a gradient fabric. To make the two cups look like they were part of a set, I appliqued the same flower that I fussy cut out of a print fabric onto the cup portion of the block. I also chose a fabric that coordinated with the half-square triangles for the borders of my tea cup blocks.